



CITY OF ESCONDIDO
CENTERLINE INTERSECTION TIES

TIE # 523-A

DATE: 9/2014

10TH AVE @ PINE ST.

DRAWN: PF

CHECKED: PF

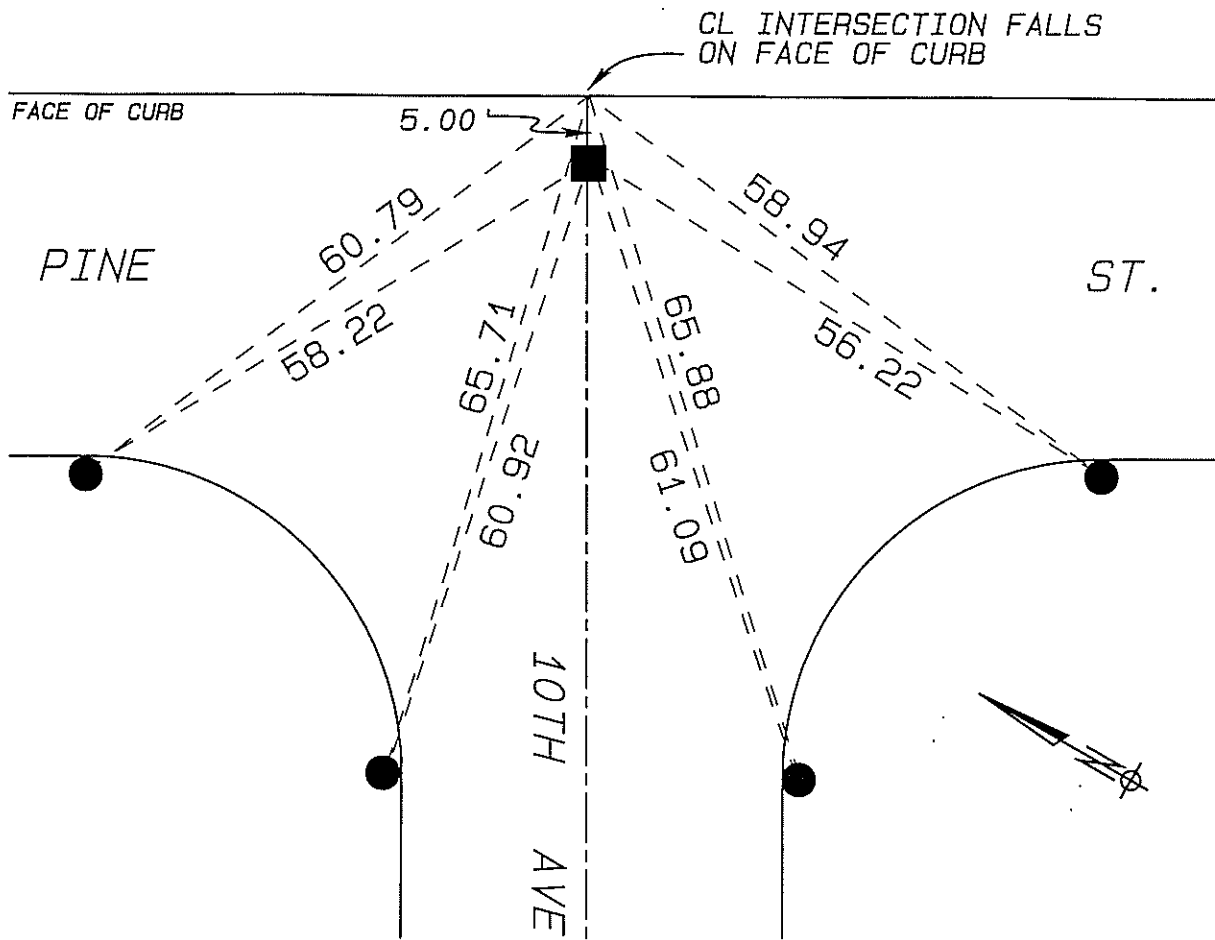

■ — FOUND NAIL AND TAG IN PAVEMENT MARKED "LS 4539" ON 5.00' OFFSET TO C/L INTERSECTION PER ROS 13420.

● — FOUND CHISELED 'X' IN TOP OF CURB PER CITY TIESHEET #523, SET LEAD AND TACK IN CENTER OF FOUND 'X'.