



# CITY OF ESCONDIDO

## CENTERLINE INTERSECTION TIES

TIE # 471-A

DATE: 5/2015

9TH AVE @ MAPLE STREET

DRAWN: PF

CHECKED: PF

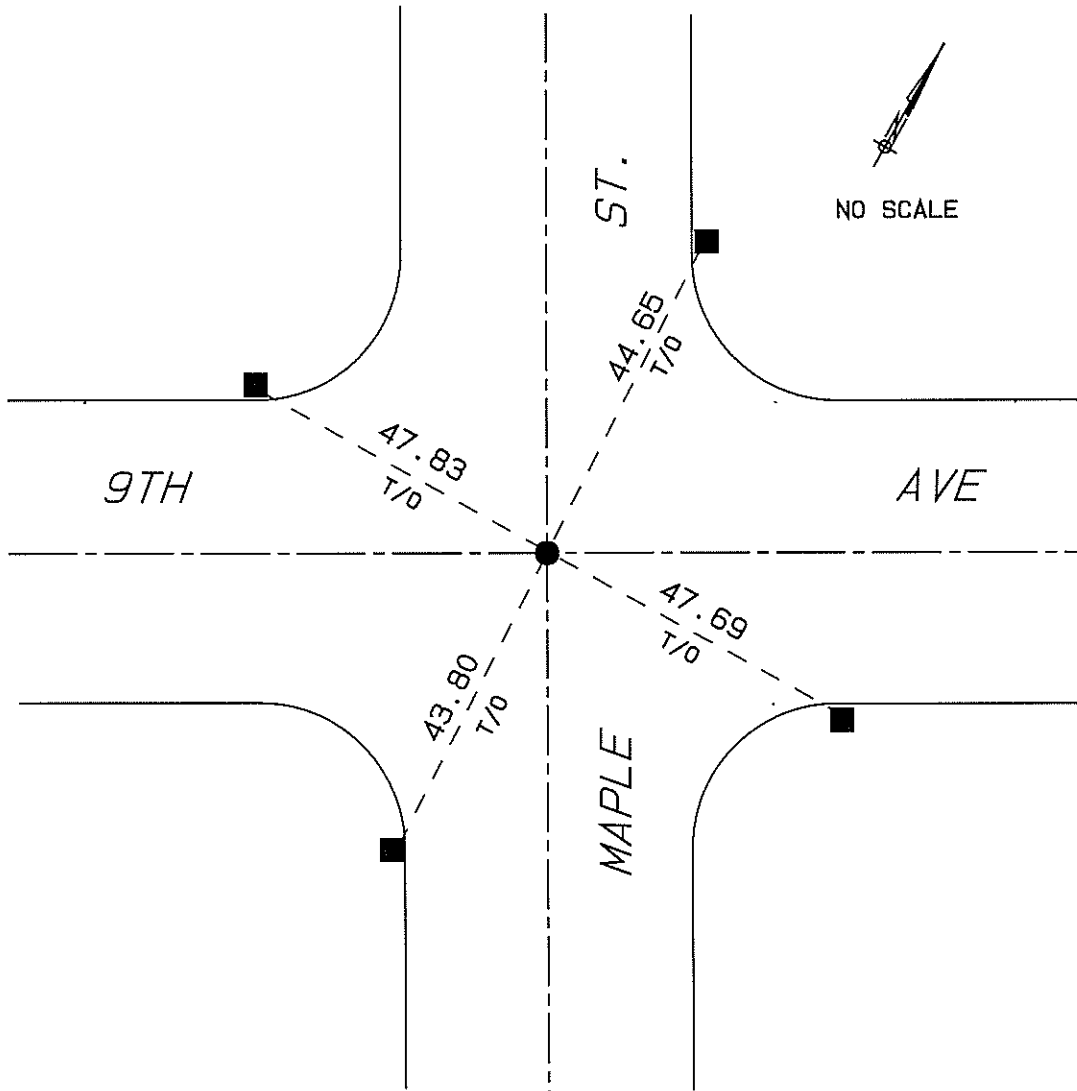

● — FOUND 5/8" PIN IN HOLE IN ASPHALT ROADWAY, DOWN 7".  
SEE RECORD OF SURVEY 10800. SET SPIKE AND WASHER  
IN NEWLY PAVED ROAD SURFACE AT SAME POSITION AFTER  
CONSTRUCTION. SEE CORNER RECORD 36912.

■ — LEAD AND TACK IN TOP OF CURB