

CENTERLINE TIES EAST SEVENTH AVENUE TRACT A05

12-29-80
Ties checked
P. Cherry

RECEIVED
DEC 18 1980
CITY OF ESCONDIDO
PUBLIC WORKS DEPT.

12-13-1980
104-80

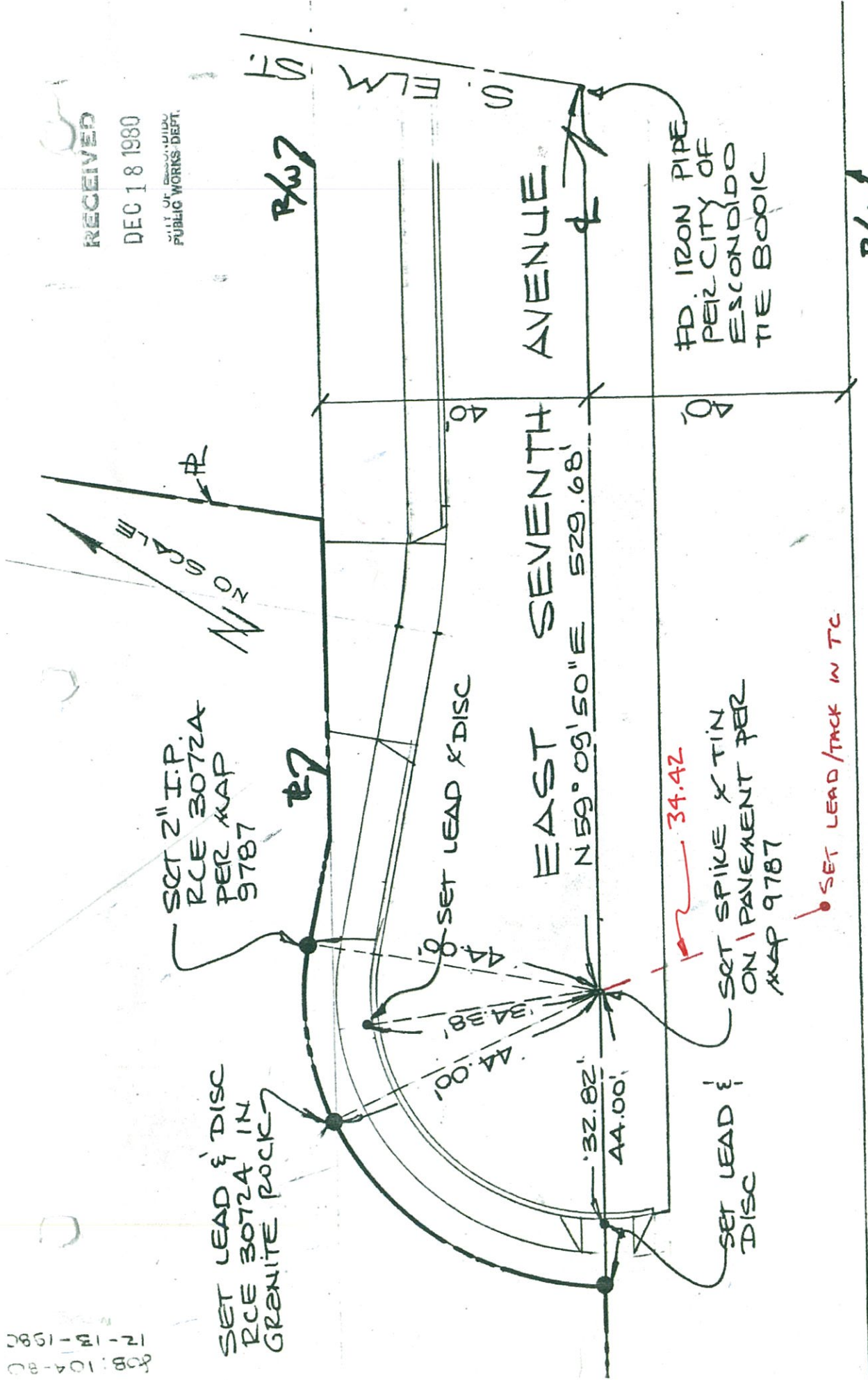

SET 2" I.P.
RCE 3072A
PER MAP
9787

SET LEAD & DISC
RCE 3072A IN
GRANITE ROCK

SET LEAD & DISC

EAST SEVENTH AVENUE
N 59° 09' 50" E 529.68'

FD IRON PIPE
PER CITY OF
ESCONDIDO
THE BOOK

SET SPIKE & TIN
ON PAVEMENT PER
MAP 9787

SET LEAD &
DISC

SET LEAD/TACK IN TC

R/W

R/W

0. ELM ST.

R/W

44.00'

34.38'

44.00'

32.82'

44.00'

34.42