







LIGHTING AND EFFECTS

Brushstrokes

-  1 EXISTING TREES
-  2 MUSEUM WALL MURAL
-  3 GATEWAY
-  4 NEW TREES
-  5 EXISTING SIDE TRAIN CAR
-  6 EXISTING WALL
-  7 PROJECTED SHADOWS



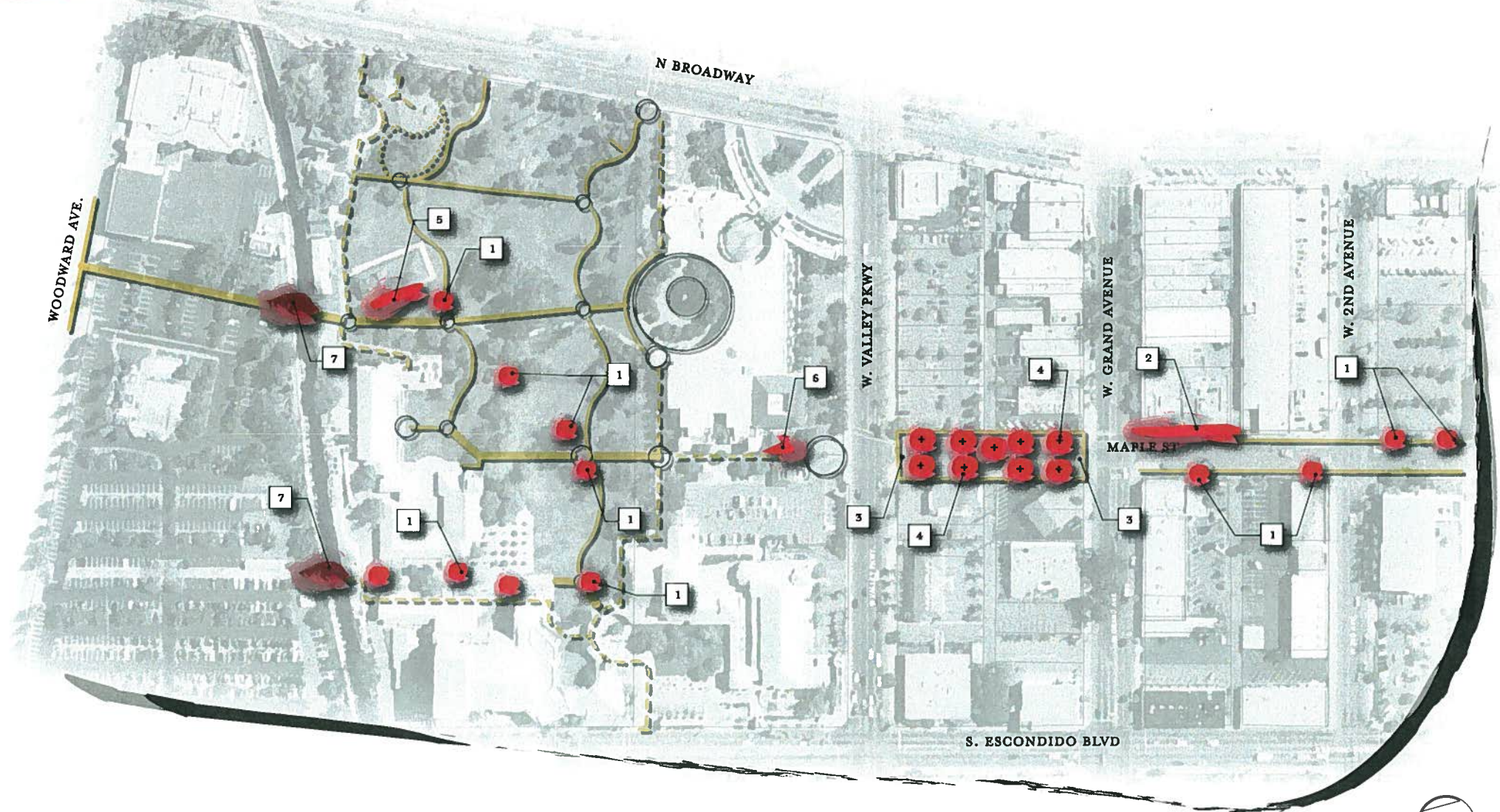

Lighting colors and patterns for the entire corridor will be computer controlled for slow color fade which can be programmed to change color slowly and for special events. Colorful LED lighting will provide a unifying element and a unique method of highlighting visual elements along the corridor, including:

- Intermittently selected existing trees and new trees along the Maple Street corridor and in Grape Day Park will be lighted with color LED lighting.
- The existing Mingei Museum wall mural will be lit with a color LED wall wash.
- The existing train car in Grape Day Park will be lit with color LED lighting.
- The two proposed gateway signs on Maple Street will be lighted with standard white LED lighting.
- Additional security and accent lighting will be incorporated along the corridor as needed. In areas where color LED lighting is used, bollard lights will be required.

LIGHTING

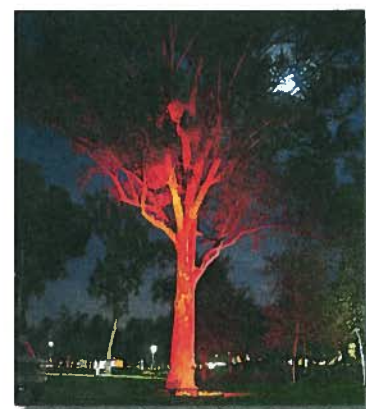
-  1 EXISTING TREES



-  5 EXISTING SIDE TRAIN CAR







SHADOWS

-  7 PROJECTED SHADOWS



SOUND

Brushstrokes

-  1 MOTION ACTIVATED SOUND OF RUNNING WATER AND "TALK TUBES" TO AMPLIFY SOUND OF CREEK RUNNING
-  2 WATER FEATURE SOUND
-  3 MUSIC SCULPTURES (RELOCATED TO NEW ENTRANCE TO CHILDREN'S MUSEUM)
-  4 WILDLIFE (BIRD SOUNDS AT PLAYGROUND AREA)

Sound along the corridor will provide another way to engage the senses and enhance new and existing elements along the corridor.

- Motion activated sound of running water will be installed with an explanation plaque at the two bridges that cross Escondido Creek to connect park users with the creek.
- Existing music feature art pieces at the City Hall will be relocated to a new Sculpture Court at the entry from Grape Day Park to the Children's Museum.
- New decorative fountain in Maple Street will create water running sound during non drought years and winter.
- Motion activated sounds of birds will be included at the play area at Grape Day Park.

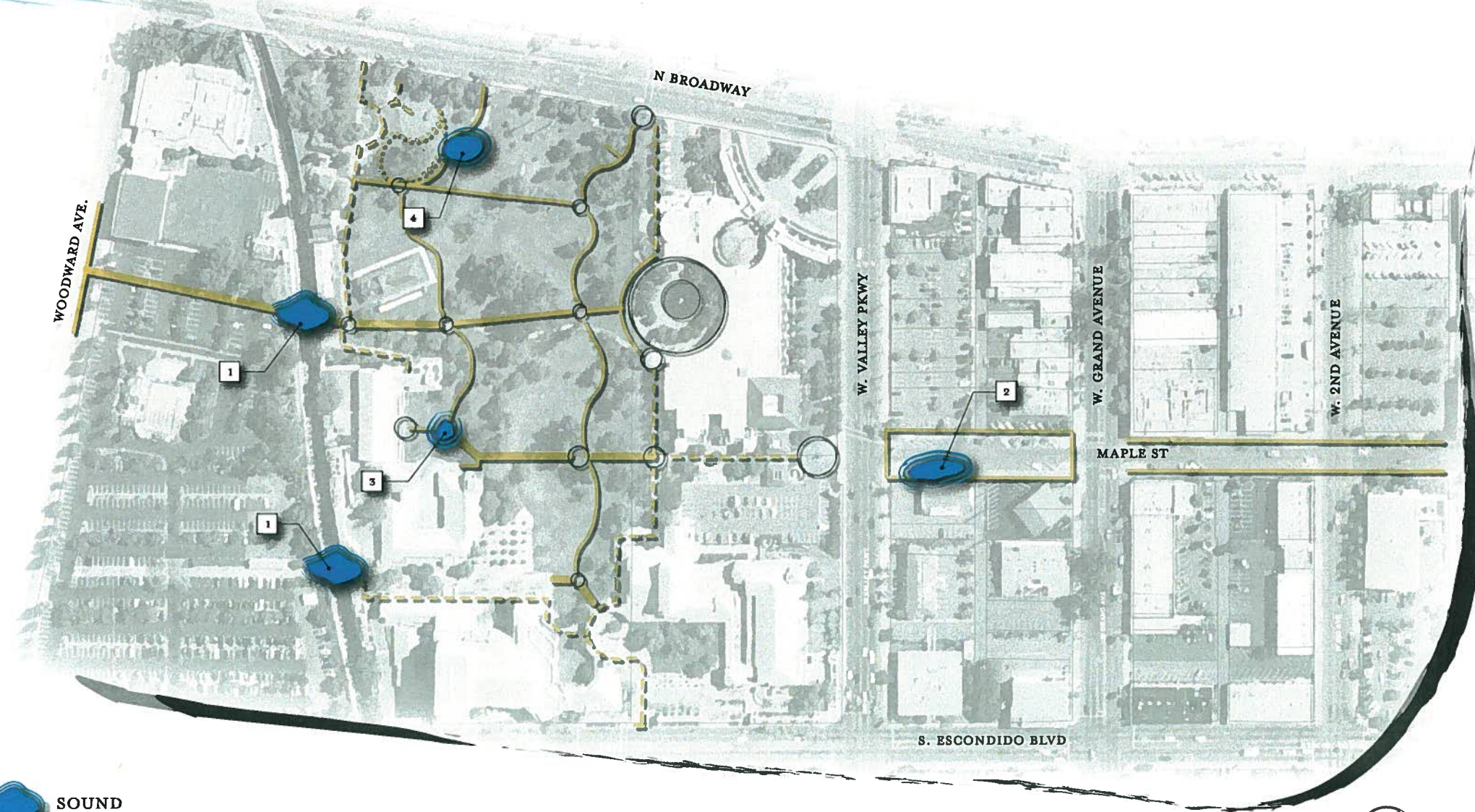

1 MOTION ACTIVATED SOUND OF RUNNING WATER

4 WILDLIFE



HARDSCAPE & PLANTING

Brushstrokes

- LOCATION OF PROPOSED NEW TREES
- NEW TREES TO BE LIT WITH COLOR LED BRUSHSTROKES EFFECT
- EXISTING TREES TO BE LIT WITH COLOR LED
- EXISTING TREES TO BE REMOVED
- NEW CONCRETE PAVING
- NEW DECORATIVE AND HISTORIC PAVERS
- NEW PAVERS ALONG EXISTING SIDEWALKS
- HISTORIC ENGRAVED PAVERS
- REPLACE EXISTING D.G. WITH COMPACTED STABILIZED D.G. OR DECORATIVE CONCRETE PAVING
- REPLACE EXISTING D.G. WITH COMPACTED STABILIZED D.G.
- - - EXISTING PAVING
- NEW STAIRS AT CITY HALL FOUNTAIN, TRAIN DEPOT, AND CHILDREN'S MUSEUM
- PROGRAMMATIC NODES WITH DECORATIVE PAVERS TO INCLUDE HISTORIC ENGRAVED PAVERS, ART AND SEATING OPPORTUNITIES
- EXPANDED PLAY AREA
- ▼ 3-SIDED KIOSKS
- 2-SIDED KIOSKS
- GATEWAY SIGNAGE
- Ⓧ DIRECTIONAL SIGNS

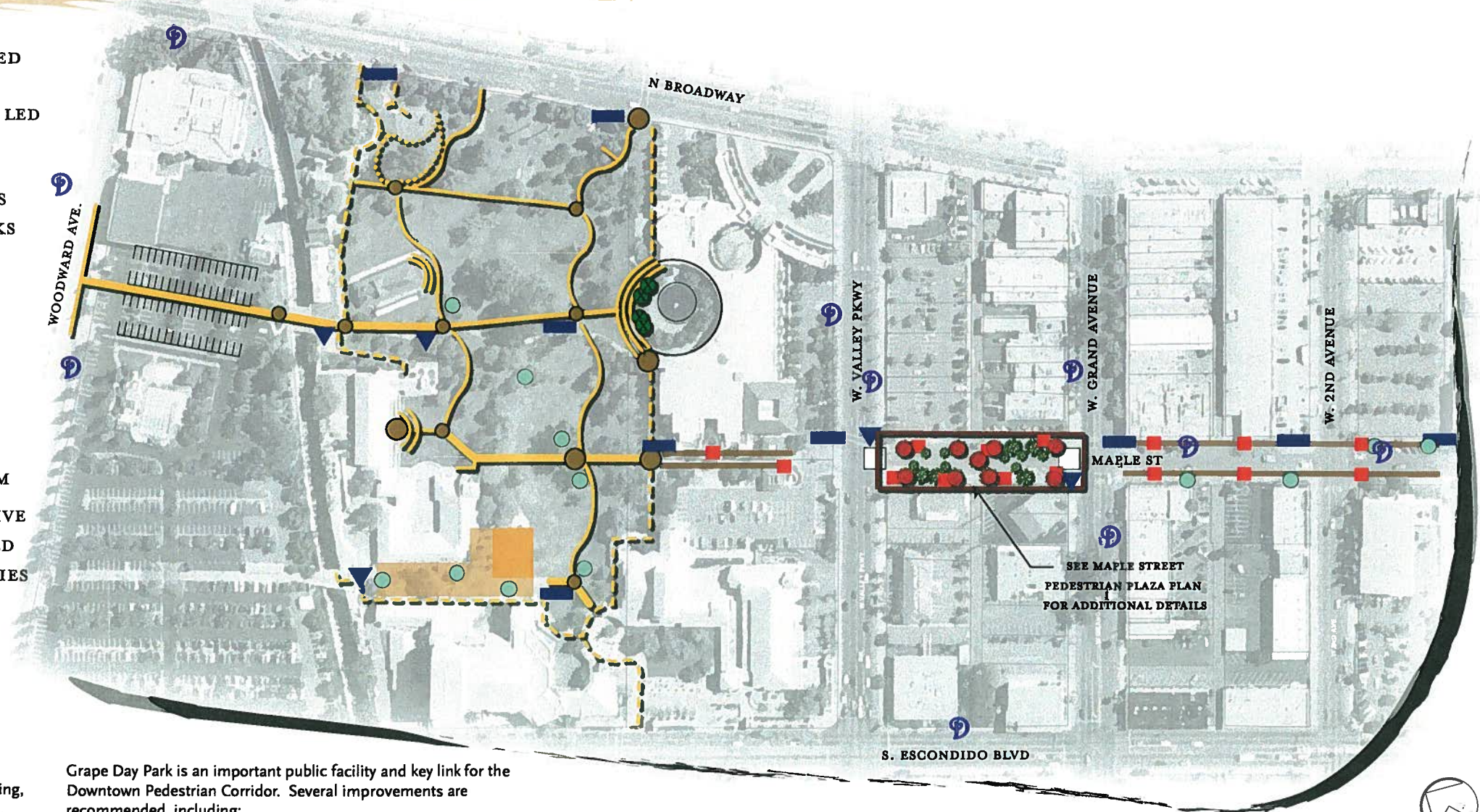

New hardscape, planting, and signage will enhance the identity of the corridor and provide unifying visual elements to provide wayfinding, historic references, and enhanced hardscape and landscape features.

Grape Day Park is an important public facility and key link for the Downtown Pedestrian Corridor. Several improvements are recommended, including:

- Historic engraved pavers with interesting facts about Escondido will be placed in linear patterns along the sidewalk and curb along Maple Street between West Grand Avenue and the alley south of West 2nd Avenue. Information will be etched into pavers and bordered with mosaic tiles in patterns that are reminiscent of Niki De Saint Phalle. The remaining area not taken by decorative pavers or mosaics will be paved with matching pavement to the sidewalk (whether new or existing). Linear accents of historic engraved pavers and tile will provide highlights within the Maple Street Pedestrian Plaza.
- Existing trees on Maple Street between Grand Avenue and West Valley Parkway will be removed and replaced.
- Kiosks will be placed along the corridor and in Grape Day Park. Gateway signage is proposed for Maple Street at West Grand Avenue and West Valley Parkway. Directional signage will be positioned along Maple Street and on several cross streets of Maple Street.
- To improve circulation in Grape Day Park, an asymmetric grid pattern of new pathways is recommended. At the intersections of the crossing pathways in Grape Day Park, the nodes will create opportunities to add seating, art elements, and historic engraved paver stones. For consistency, the nodes should be circular in shape, with decorative pavers to match the corridor pavers, and should include historical reference.
- It is proposed to remove several trees at the City Hall fountain that face Grape Day Park (north side of the fountain) and provide wide stairs in order to open views and create a connection between the fountain and Grape Day Park. Existing planters are to remain.
- A new enhanced entry to the Children's Museum will include stairs opening towards the park and a plaza with relocated music sculptures.
- The parking lot north of Grape Day Park should be reorganized, with the addition of a pedestrian link to Woodward Avenue.
- The children's play area should be expanded to include signature play activities and a theme that will enhance the park as a destination.

HISTORIC ENGRAVED PAVERS



CORRIDOR PAVERS

- MOSAIC TILES LOCATED PERIODICALLY ALONG CORRIDOR TO PROVIDE ACCENT COLOR
- HISTORIC ENGRAVED PAVERS
- MOSAIC TILES FRAME HISTORIC ENGRAVED PAVERS (SEE EXAMPLE AT RIGHT)
- 12" WIDE DECORATIVE PAVERS AT CURB ADJACENT TO EXISTING PAVING
- EXISTING PAVING TO REMAIN

HISTORIC ENGRAVED PAVER STONES ALONG CORRIDOR AND AT PROGRAMMATIC NODES IN GRAPE DAY PARK

MOSAIC TILES (EXAMPLE) BY ARTIST PAUL HOBSON (AS TRIBUTE TO NIKI DE SAINT PHALLE)

